

OUT AREAS SHOW WHERE
OR OTHER SERVICES RUN ALONG
E.G. EXACT CLEARANCE SHOULD BE
ON SITE.

THE NATURE OF THE BUILDING -
IS VICTORIAN BUILDING - ALL
NO FURTHER REVISIONS - ALL
IT SHOULD BE CHECKED ON SITE
FUTURE VARY ALONG THE LENGTH
ITEM SHOWN - PLEASE CHECK

TO THE VARIOUS BEAMS AND
OF ALONG THEIR LENGTH - A
HEIGHT HAS BEEN GIVEN BUT
VARY AT A SPEED TO POINT

NEVER STEEL STRUCTURES
HEIGHT ALONG THEIR LENGTH -
CHECK FOR SPECIFIC CLEARANCES

HITS RELATIVE TO POSITION ON
THE BETWEEN THE ROOF

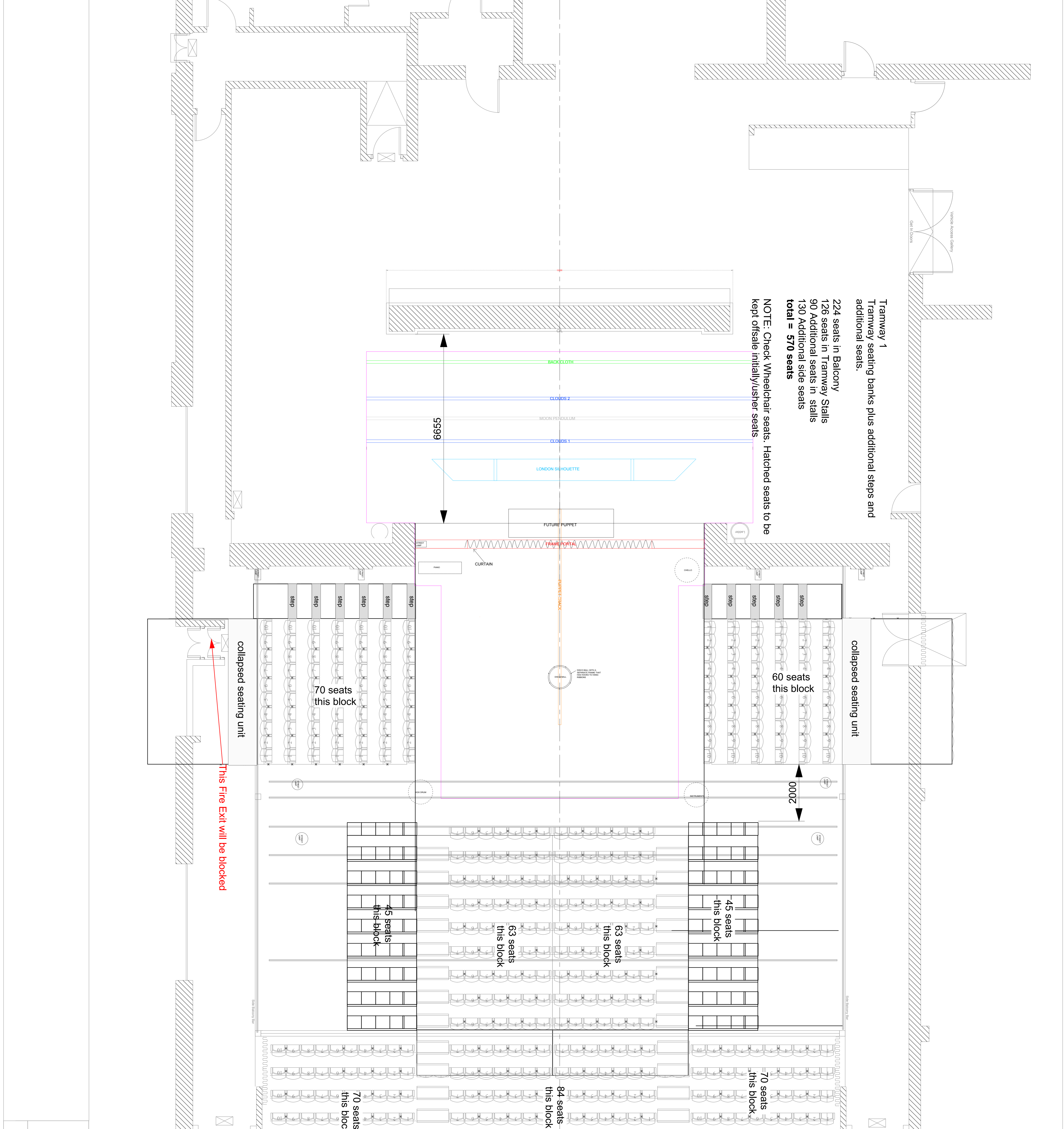
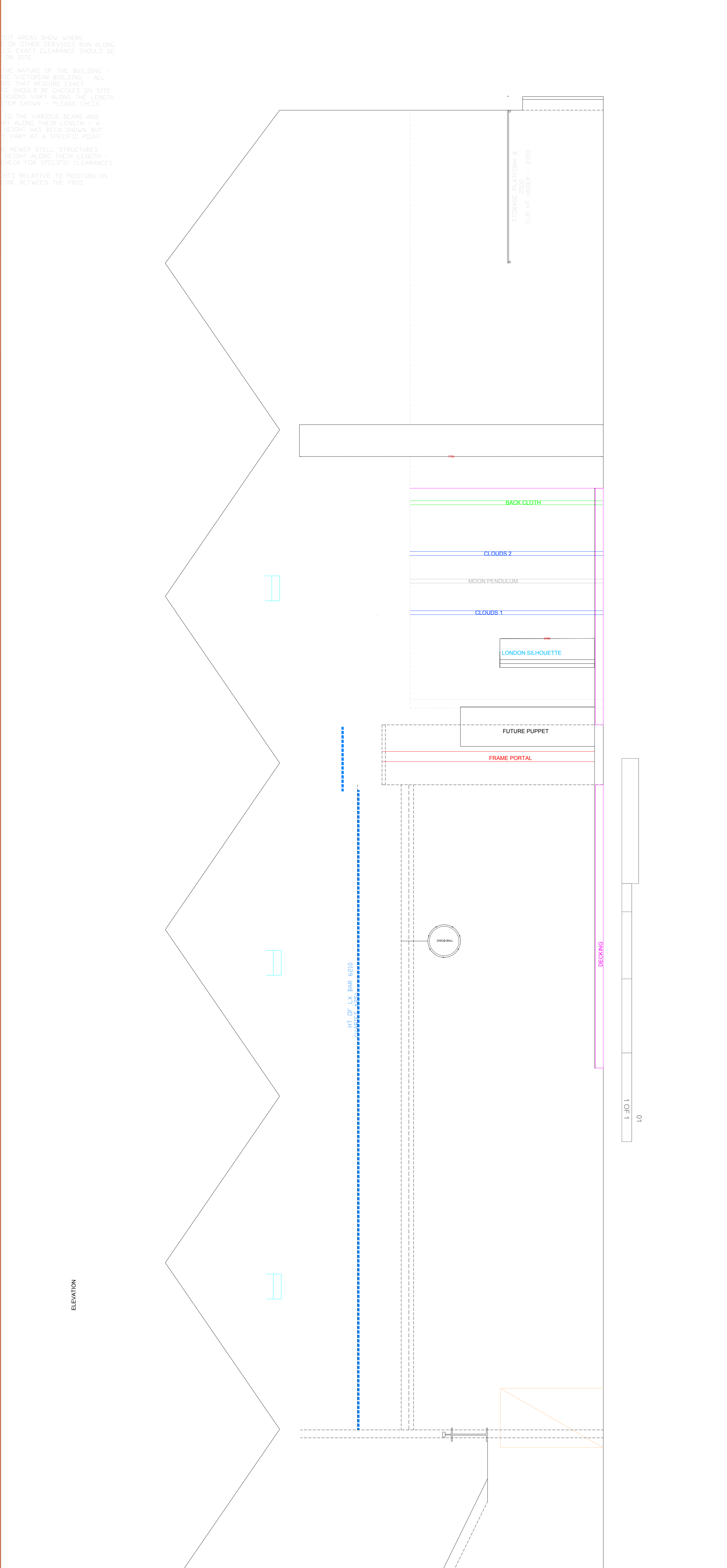

<p>PLEASE NOTE THIS DRAWING REPRESENTS VISUAL CONCEPTS AND CONSTRUCTION BLOCKS ONLY. THE DRAUGHTSMAN IS QUALIFIED TO OBTAIN THE STRUCTURAL APPROPRIATENESS OF THIS DESIGN AND WILL NOT BE RESPONSIBLE FOR IMPROPER ENGINEERING, CONSTRUCTION, FIXINGS, HANDLING OR USE OF THIS SCHEME. IF PROFESSIONAL ADVICE DOCUMENTATION IS RECOMMENDED, IT MUST BE SOUGHT.</p> <p>ALL MATERIALS AND CONSTRUCTION MUST COMPLY WITH LOCAL FIRE AND SAFETY REGULATIONS. IF IN DOUBT, ASK</p> <p>ALL DIMENSIONS IN MM UNLESS STATED OTHERWISE.</p>		<p>#PROJECT #VENUE</p>	<p>DATE 15/08/18</p>	<p>SCALE Custom 1.50</p>
<p>#DEPT ###</p>	<p>DESIGN DRAWINGS.dwg</p>	<p>RF NUMBER CHRIS/MAS/CAR#</p>	<p>RF NUMBER 15/08/18</p>	<p>RF NUMBER Custom 1.50</p>
<p>RF# 15/08/18</p>	<p>RF# 15/08/18</p>	<p>RF# 15/08/18</p>	<p>RF# 15/08/18</p>	<p>RF# 15/08/18</p>
<p>RF# 15/08/18</p>	<p>RF# 15/08/18</p>	<p>RF# 15/08/18</p>	<p>RF# 15/08/18</p>	<p>RF# 15/08/18</p>

FLOOR PLAN OF PARKAY FLOORING



PLEASE NOTE
 THIS DRAWING REPRESENTS VISUAL CONCEPTS AND CONSTRUCTION SUGGESTIONS ONLY. THE DRAUGHTSPERSON IS UNQUALIFIED TO DETERMINE STRUCTURAL APPROPRIATENESS OF THIS DESIGN AND WILL NOT BE RESPONSIBLE FOR IMPROPER ENGINEERING, CONSTRUCTION, RIGGING, HANDLING OR USE OF THIS SCENERY. IF PROFESSIONAL ADVICE/ DOCUMENTATION IS RECOMMENDED, IT MUST BE SOUGHT.
 ALL MATERIALS AND CONSTRUCTION MUST COMPLY WITH LOCAL FIRE AND SAFETY REGULATIONS. IF IN DOUBT... ASK!
 ALL DIMENSIONS IN MM UNLESS STATED OTHERWISE.

PROJECT	#PROJECT		VENUE	#VENUE
SHEET TITLE	L DESIGN DRAWINGS.dwg			
DEPT	#DEPT			
DESIGNED BY	BLX	PROJECT MANAGER	BPM	DRAWN BY
DRAWN BY	BLX	PROJECT MANAGER	BPM	LUNED
CHECKED BY	BDS	PROJECT OFFICE	#DOFFICE X###	NOT CHECKED

DATE: 15/08/18
 SCALE: Custom 1.25 A1P
 REF. NUMBER: CHRIS/MAS/CAR# /9

FRONT FRAMES

PLAN

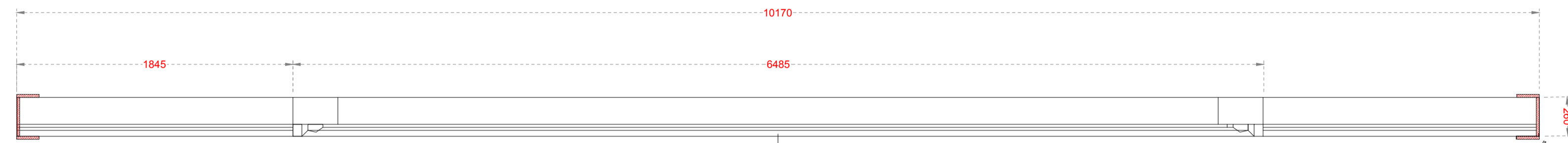

FRONT ELEVATION

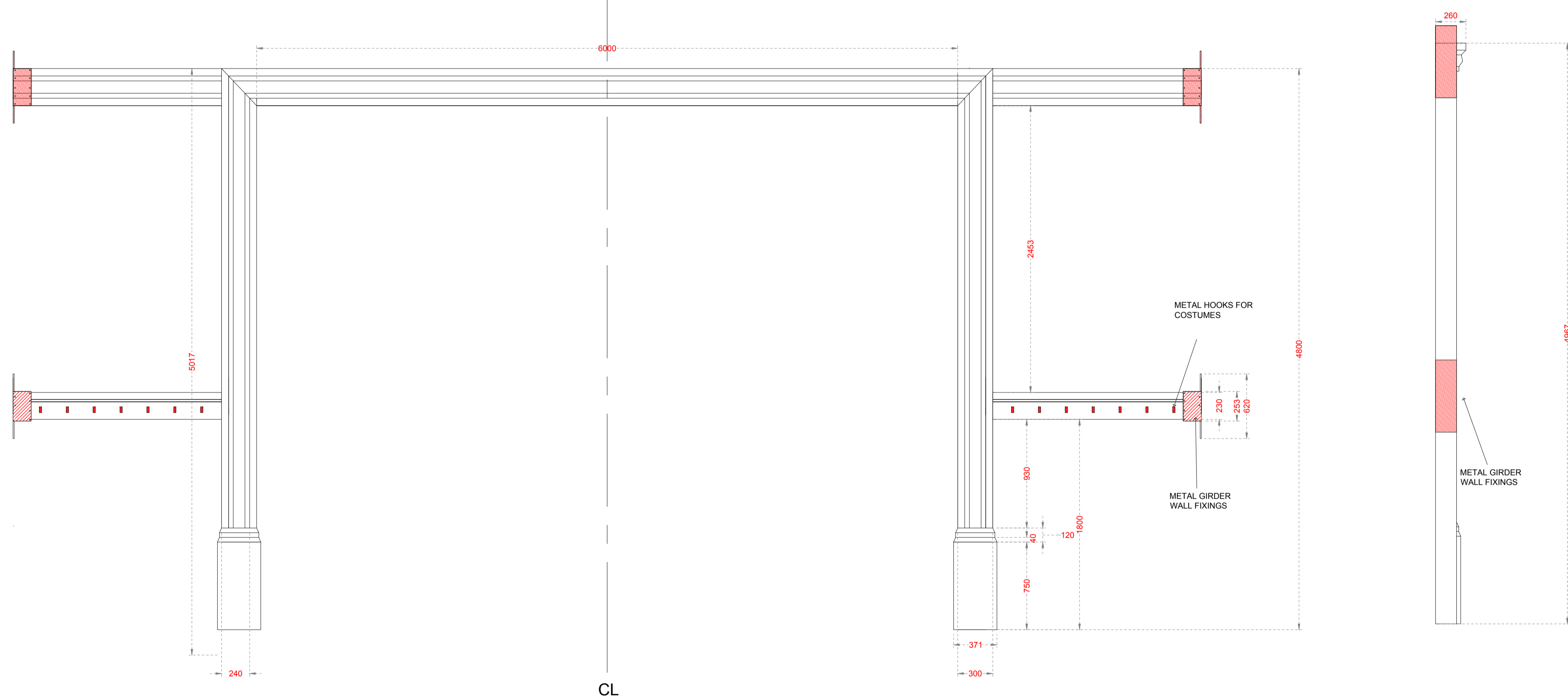

NOTES:
 - METAL INDUSTRIAL GIRDER ATTACHMENTS TO SIDE OF FRAME TO ATTACH TO WALL
 - WOODEN MOLDINGS TO GIVE DETAIL TO FRAME
 - BOTH SIDES OF LOWER LEVEL METAL HOOKS ON BOTTOM SIDES OF FRAME FOR COSTUMES
CURTAIN
 - CURTAIN IS 2X @3000 CURTAINS EXTRA LENGTH FOR PLEATS
 - TRACK @ 10160MM FULL LENGTH TO FIT BETWEEN TWO WALLS
 - WHEN CURTAINS OPEN WILL SIT BEHIND SIDE SECTIONS OF FRAME CURTAIN
INDUSTRIAL SILHOUETTE
 - WILL BE MADE OUT OF PLANT POTS - POTS TO SMOKE

<p>PLEASE NOTE</p> <p>THIS DRAWING REPRESENTS VISUAL CONCEPTS AND CONSTRUCTION SUGGESTIONS ONLY. THE DRAUGHTSPERSON IS UNQUALIFIED TO DETERMINE STRUCTURAL APPROPRIATENESS OF THIS DESIGN AND WILL NOT BE RESPONSIBLE FOR IMPROPER ENGINEERING, CONSTRUCTION, RIGGING, HANDLING OR USE OF THIS SCENERY. IF PROFESSIONAL ADVICE/ DOCUMENTATION IS RECOMMENDED, IT MUST BE SOUGHT.</p> <p>ALL MATERIALS AND CONSTRUCTION MUST COMPLY WITH LOCAL FIRE AND SAFETY REGULATIONS. IF IN DOUBT... ASK!</p> <p>ALL DIMENSIONS IN MM UNLESS STATED OTHERWISE.</p>		<p>PROJECT: #PROJECT #VENUE</p> <p>SHEET TITLE: L DESIGN DRAWINGS.dwg</p> <p>#DEPT #####</p>		<p>DATE: 15/08/18</p> <p>SCALE: Custom 1.25_{ATL}</p>
<p>Tel: 020 7452 3333</p> <p>Fax: 020 7452 3400</p> <p>www@nikontheatre.org.uk</p>	<p>DESIGNER: #LX</p> <p>DRAWN: #SND</p>	<p>PROJECT MANAGER: #PM</p> <p>DESIGN OFFICE: #SDOFFICE X####</p>	<p>WORK BY: #LUNED</p> <p>APPROVED BY: #NOT CHECKED</p>	<p>REF NUMBER: CHRIS/MAS/CAR# /9</p>

ROOF TOP POTS

FRONT ELEVATION

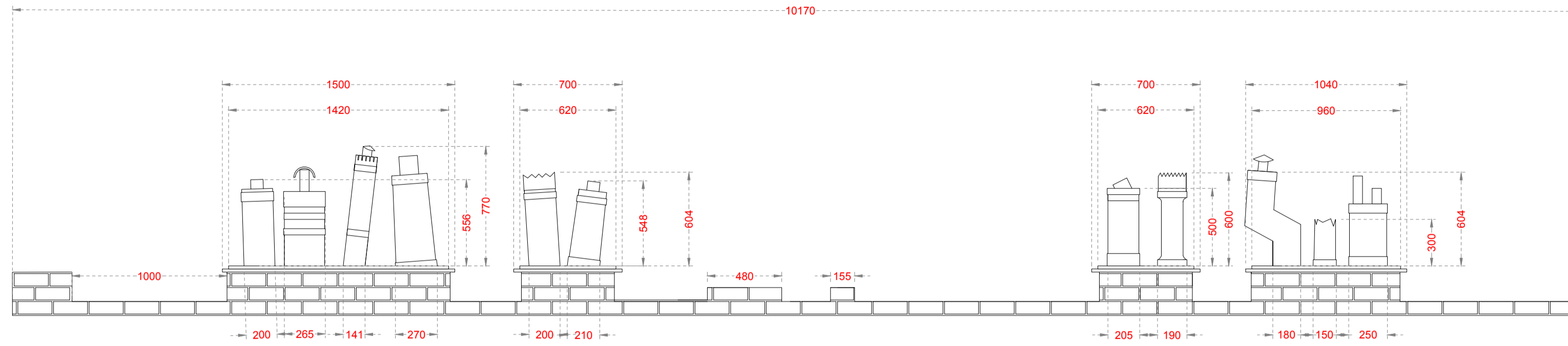

NOTES:
 - REFERENCE WILL BE PROVIDED FOR CHIMNEY POTS FOR DETAIL
 - SMOKE TO COME FROM POTS - TO BE DISCUSSED

PLAN

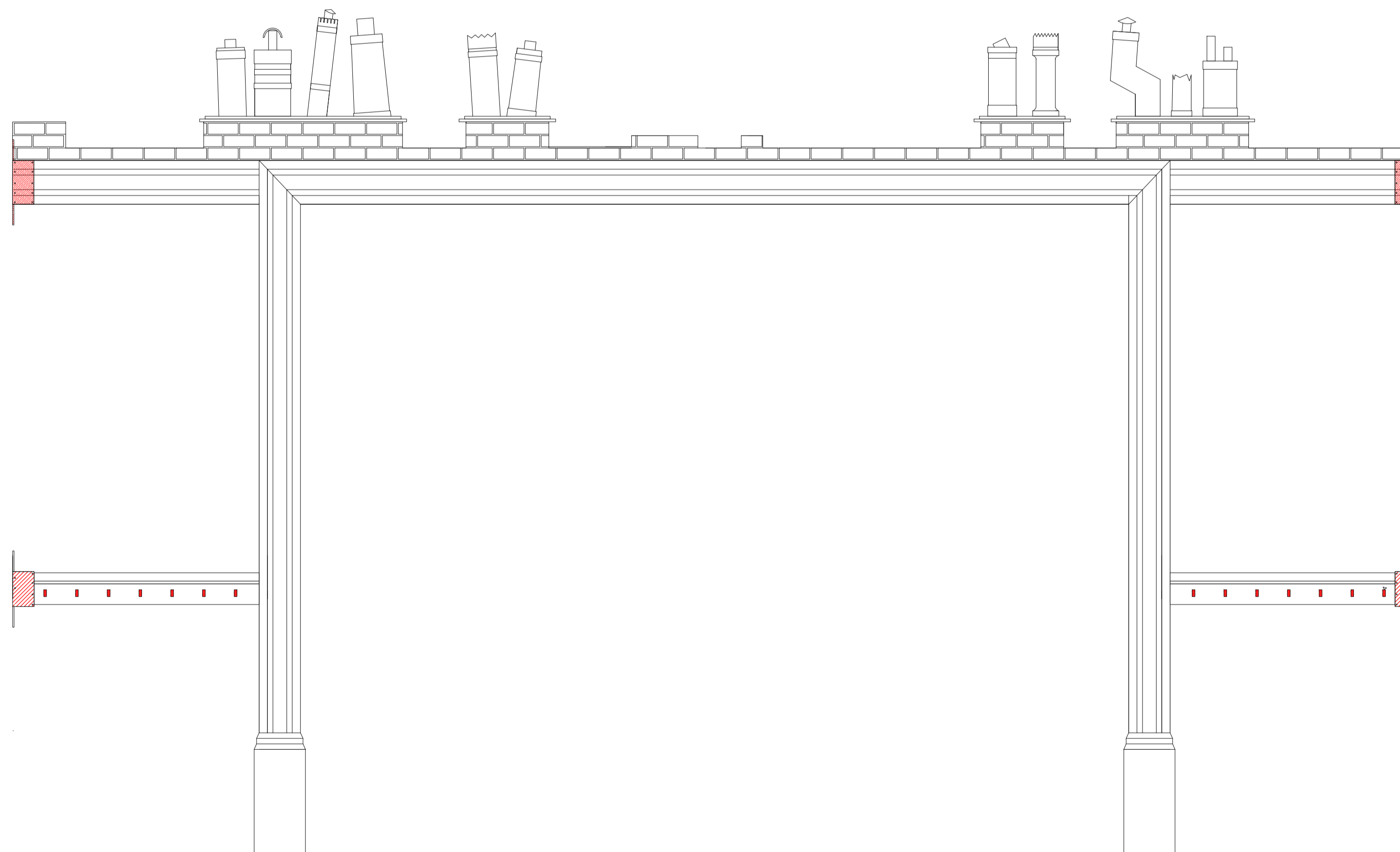
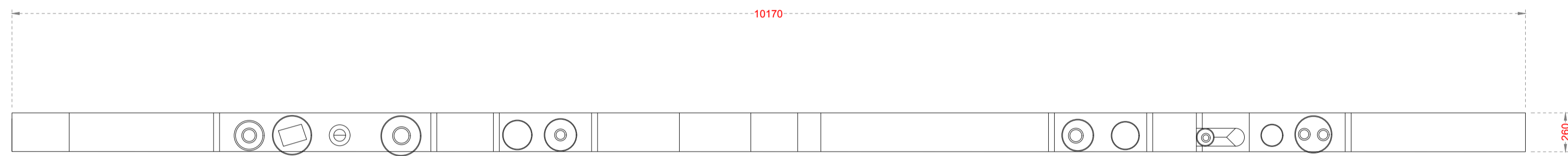

SILHOUETTE LONDON - NO1

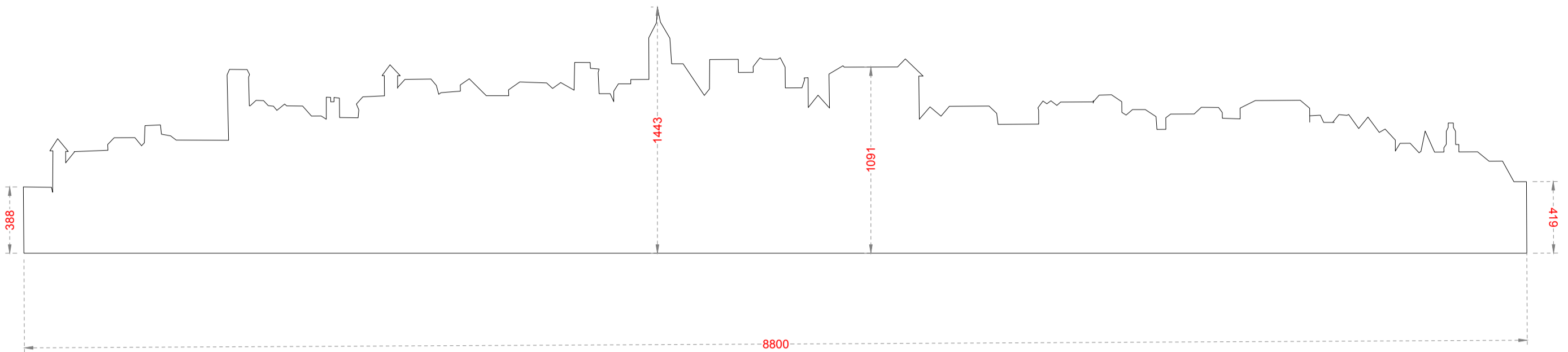

FRONT ELEVATION

SILHOUETTE LONDON - NO2

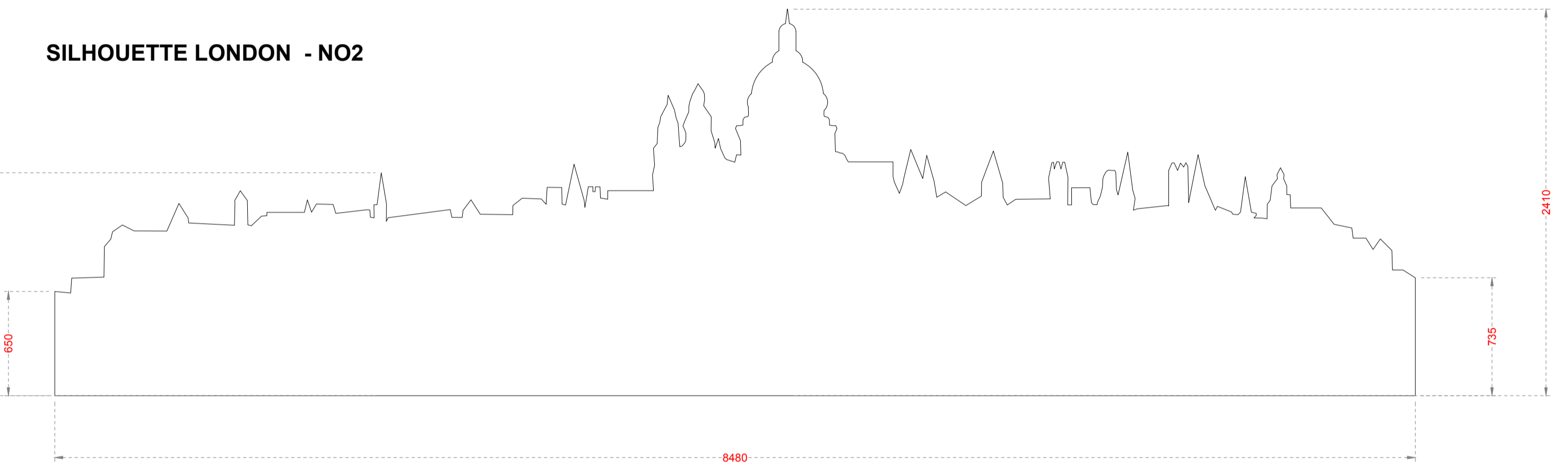

FRONT ELEVATION

SILHOUETTE LONDON - NO3

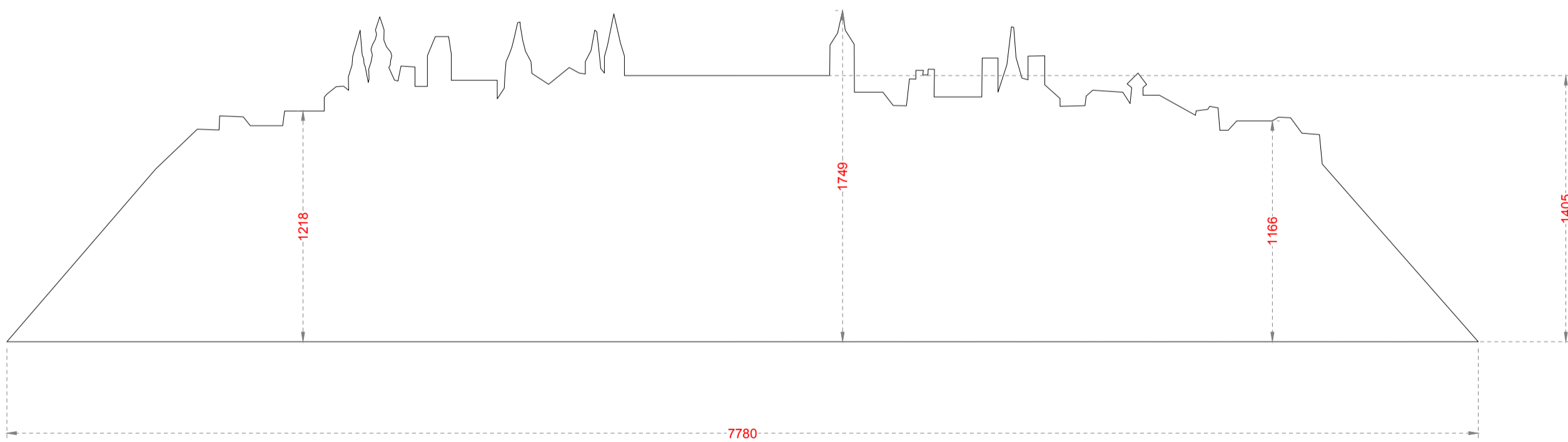

FRONT ELEVATION

PLEASE NOTE

THIS DRAWING REPRESENTS VISUAL CONCEPTS AND CONSTRUCTION SUGGESTIONS ONLY. THE DRAUGHTSPERSON IS UNQUALIFIED TO DETERMINE STRUCTURAL APPROPRIATENESS OF THIS DESIGN AND WILL NOT BE RESPONSIBLE FOR IMPROPER ENGINEERING, CONSTRUCTION, RIGGING, HANDLING OR USE OF THIS SCENERY. IF PROFESSIONAL ADVICE/ DOCUMENTATION IS RECOMMENDED, IT MUST BE SOUGHT.
ALL MATERIALS AND CONSTRUCTION MUST COMPLY WITH LOCAL FIRE AND SAFETY REGULATIONS. IF IN DOUBT... ASK!

ALL DIMENSIONS IN MM UNLESS STATED OTHERWISE.

PROJECT: #PROJECT SHEET TITLE: L DESIGN DRAWINGS.dwg	VENUE: #VENUE		DATE: 15/08/18	SCALE: Custom 1.25
	#DEPT ####		REF. NUMBER: CHRIS/MAS/CAR##	/9
DIRECTOR: #DIR DESIGNER: #DES	LIGHTING DESIGNER: #LX SOUND DESIGNER: #SND	PRODUCTION MANAGER: #PM 3D OFFICE CONTACT: #3DOFFICE X###	DRAWN BY: LUNED APPROVED BY: NOT CHECKED	
Tel: 020 7452 3333 Fax: 020 7452 3430 luned@nationaltheatre.org.uk				

BED

- NOTES:
- BED WITH CASTORS WITH BREAKS (DEPENDING ON REHERSALS)
 - DETAIL LIGHT BULB ON BACK OF BED FRAME
 - METAL FRAME - SOURCED BED

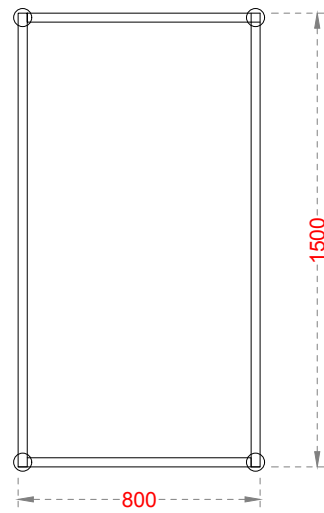

PLAN

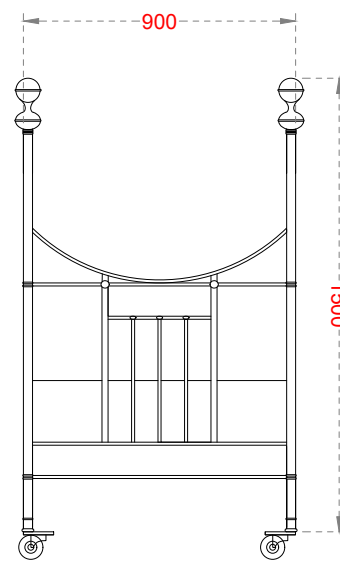

FRONT ELEVATION

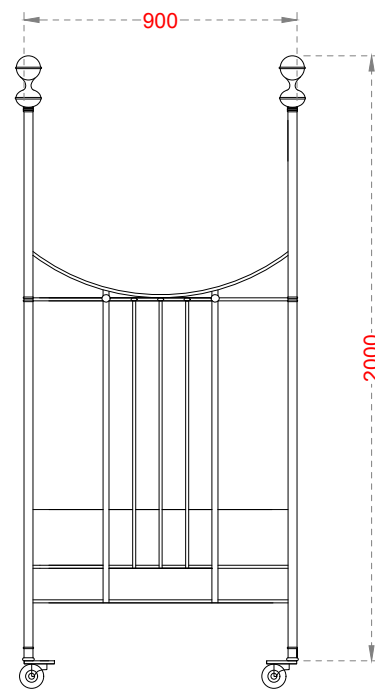

BACK ELEVATION

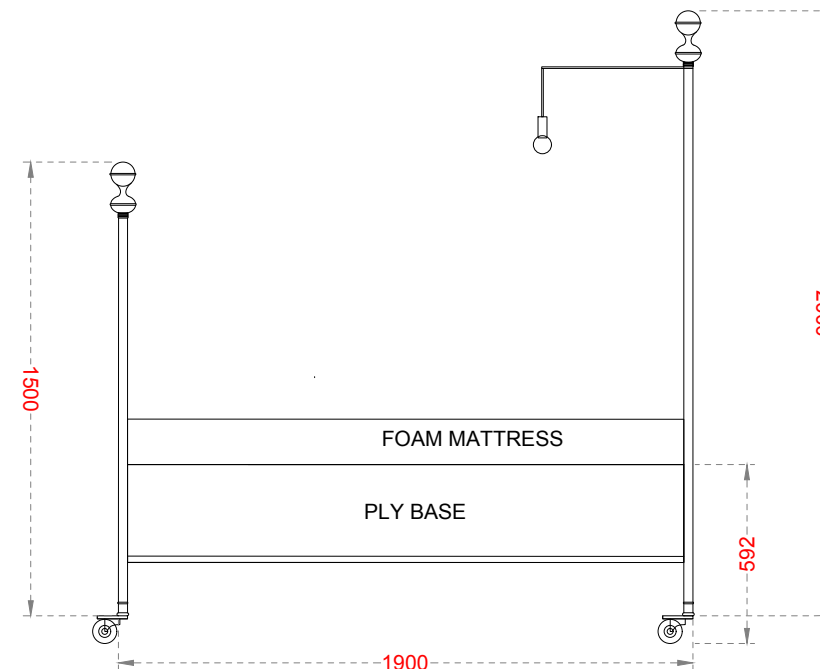

SIDE ELEVATION

PLEASE NOTE

THIS DRAWING REPRESENTS VISUAL CONCEPTS AND CONSTRUCTION SUGGESTIONS ONLY. THE DRAUGHTSPERSON IS UNQUALIFIED TO DETERMINE STRUCTURAL APPROPRIATENESS OF THIS DESIGN AND WILL NOT BE RESPONSIBLE FOR IMPROPER ENGINEERING, CONSTRUCTION, RIGGING, HANDLING OR USE OF THIS SCENERY. IF PROFESSIONAL ADVICE/ DOCUMENTATION IS RECOMMENDED, IT MUST BE SOUGHT. ALL MATERIALS AND CONSTRUCTION MUST COMPLY WITH LOCAL FIRE AND SAFETY REGULATIONS. IF IN DOUBT... ASK!

ALL DIMENSIONS IN MM UNLESS STATED OTHERWISE.

#DEPT

luned_gwaw@hotmail.com

PROJECT: #PROJECT CHRISTMAS CAROL

SHEET TITLE: L DESIGN DRAWINGS.dwg
#####

DIRECTOR: #DIR

DESIGNER: #DES RACHAEL CANNIN

LIGHTING DESIGNER: #LX

SOUND DESIGNER: #SND

PRODUCTION MANAGER: #PM

3D OFFICE CONTACT: #3DOFFICE X####

DRAWN BY: LUNED

APPROVED BY: NOT CHECKED

VENUE: #VENUETRAMWAY

DATE: 15/08/18

SCALE: Custom1.25 @A3L

REF. NUMBER:

/MAS/CAR# /9

COFFINS

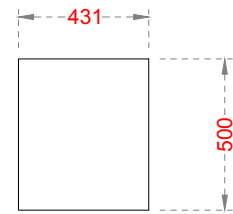

PLAN

NOTES

- 5X COFFINS - (NUMBER TO BE DISCUSSED)
- ONE WITH OPENING IN CENTER FOR ACTOR TO APPEAR
- RE-ENFORCED FOR STRENGTH
- SLATTED @100M WITH SLIGHT GAP BETWEEN SLATS
- POSSIBLE CLADDING TO BE DISCUSSED
- DISTRESSED/ROUGH LOOK

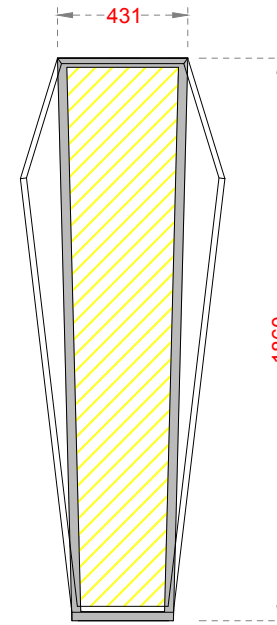

PLAN

NOTES

- NO5 COFFIN TROLLEYS
- STEEL BOX FRAME OF @30MM
- RE-ENFORCED FOR STRENGTH WITH PLY TOP
- SWIVEL CASTORS
- HANDLE AT BACK OF TROLLEY FOR EASE OF MOVING ONTO STAGE

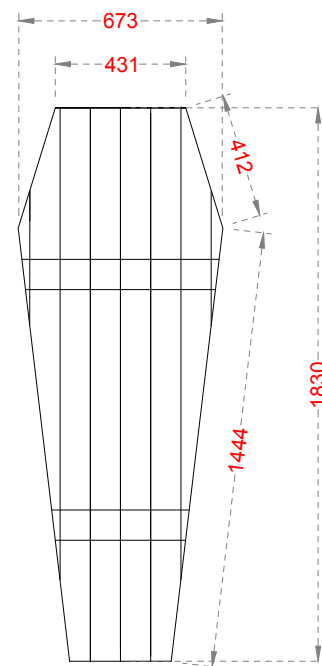

FRONT ELEVATION

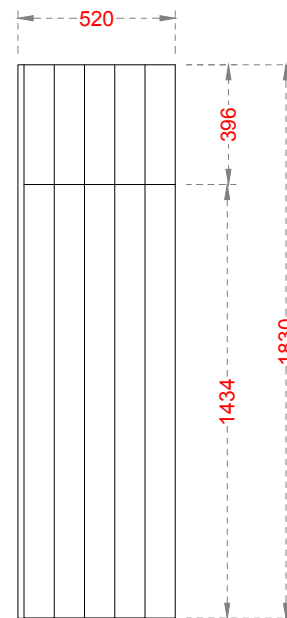

SIDE ELEVATION

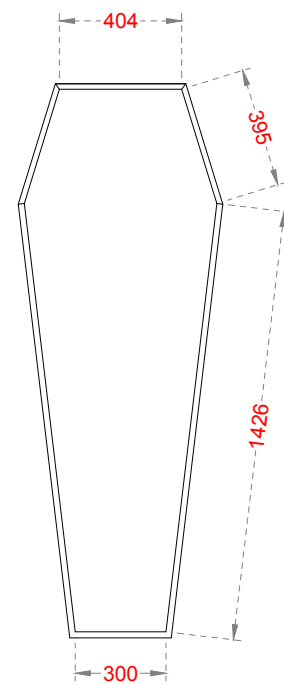

PLAN WITHOUT TOP

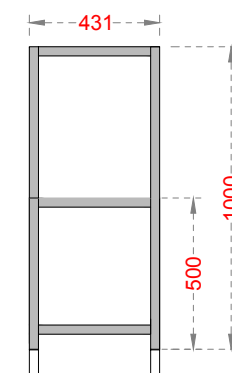

FRONT ELEVATION

CROSS BAR TO ACT AS HANDLE FOR EASE OF MOVING

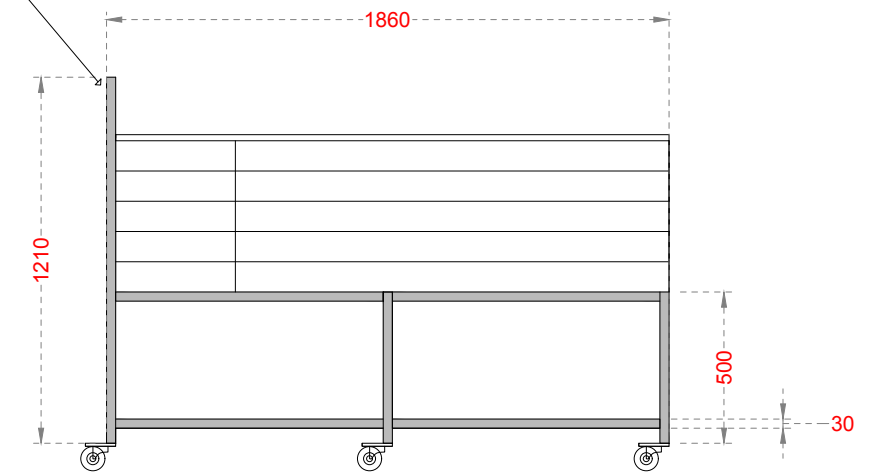

SIDE ELEVATION

PLEASE NOTE

THIS DRAWING REPRESENTS VISUAL CONCEPTS AND CONSTRUCTION SUGGESTIONS ONLY. THE DRAUGHTSPERSON IS UNQUALIFIED TO DETERMINE STRUCTURAL APPROPRIATENESS OF THIS DESIGN AND WILL NOT BE RESPONSIBLE FOR IMPROPER ENGINEERING, CONSTRUCTION, RIGGING, HANDLING OR USE OF THIS SCENERY. IF PROFESSIONAL ADVICE/ DOCUMENTATION IS RECOMMENDED, IT MUST BE SOUGHT. ALL MATERIALS AND CONSTRUCTION MUST COMPLY WITH LOCAL FIRE AND SAFETY REGULATIONS. IF IN DOUBT... ASK!

ALL DIMENSIONS IN MM UNLESS STATED OTHERWISE.

#DEPT

luned_gwawr@hotmail.com

PROJECT: #PROJECT CHRISTMAS CAROL

SHEET TITLE: L DESIGN DRAWINGS.dwg

####

####

DESIGNER: #DES RACHAEL CANNIN

DESIGNER: #DES RACHAEL CANNIN

LIGHTING DESIGNER: #LX

LIGHTING DESIGNER: #LX

LIGHTING DESIGNER: #LX

PRODUCTION MANAGER: #PM

PRODUCTION MANAGER: #PM

PRODUCTION MANAGER: #PM

DRAWN BY: LUNED

DRAWN BY: LUNED

DRAWN BY: LUNED

APPROVED BY: NOT CHECKED

VENUE: #VENUETRAMWAY

DATE: 15/08/18

SCALE: Custom1.25 @A3L

REF. NUMBER:

/MAS/CAR# /9

DOORS

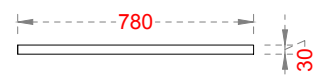

NOTES

- 3X DOORS
- MUST BE LIGHT WEIGHT FOR ACTORS TO BE ABLE TO CARY ON STAGE
- ONE - WITH HINGED CIRCULAR DOOR TO OPEN INWARDS FOR PUPPET SKULL HEAD TO OPEN INWARD
- VICTORIAN STYLE DOOR
- HANDLES ON THE BACK TO PICK UP AND OPERATE THE DOOR

PLAN

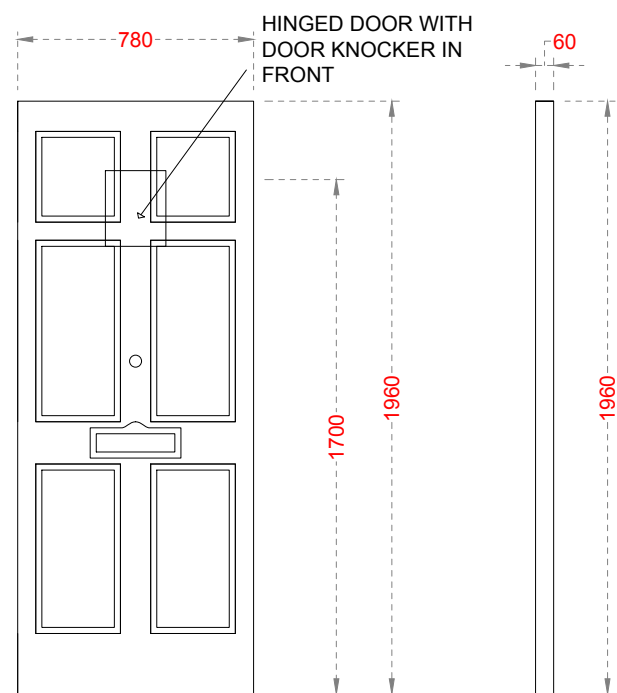

FRONT ELEVATION

SIDE ELEVATION

PLEASE NOTE

THIS DRAWING REPRESENTS VISUAL CONCEPTS AND CONSTRUCTION SUGGESTIONS ONLY. THE DRAUGHTSPERSON IS UNQUALIFIED TO DETERMINE STRUCTURAL APPROPRIATENESS OF THIS DESIGN AND WILL NOT BE RESPONSIBLE FOR IMPROPER ENGINEERING, CONSTRUCTION, RIGGING, HANDLING OR USE OF THIS SCENERY. IF PROFESSIONAL ADVICE/ DOCUMENTATION IS RECOMMENDED, IT MUST BE SOUGHT. ALL MATERIALS AND CONSTRUCTION MUST COMPLY WITH LOCAL FIRE AND SAFETY REGULATIONS. IF IN DOUBT... ASK!

ALL DIMENSIONS IN MM UNLESS STATED OTHERWISE.

#DEPT

luned_gwawr@hotmail.com

PROJECT: #PROJECT CHRISTMAS CAROL

SHEET TITLE: L DESIGN DRAWINGS.dwg

####

#DIR

DESIGNER: #DES RACHAEL CANNIN

LIGHTING DESIGNER: #LX

SOUND DESIGNER: #SND

PRODUCTION MANAGER: #PM

3D OFFICE CONTACT: #3DOFFICE X####

DRAWN BY: LUNED

APPROVED BY: NOT CHECKED

VENUE: #VENUETRAMWAY

DATE: 15/08/18

SCALE: Custom1.25 @A3L

REF. NUMBER:

/MAS/CAR## /9

LIGHT BULB HIGH CHAIR

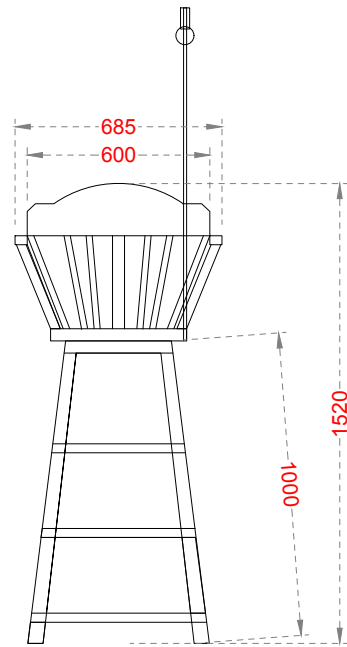

FRONT ELEVATION

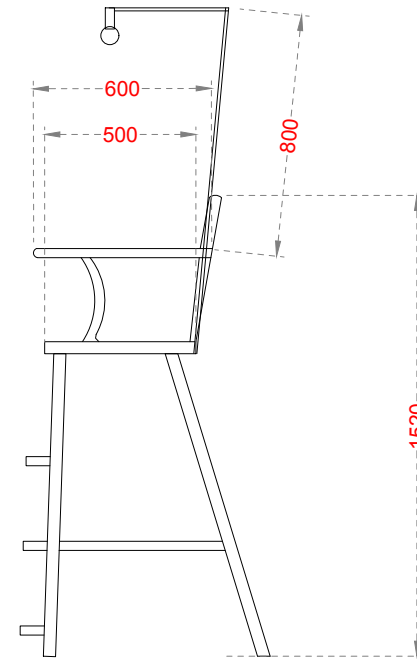

SIDE ELEVATION

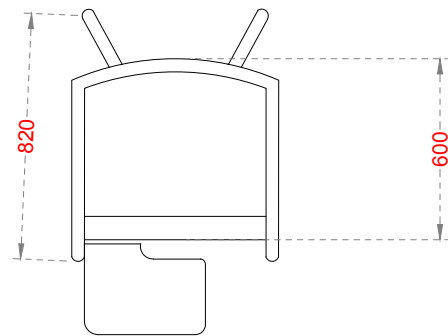

PLAN

NOTES;

- TO BE AS LIGHT AS POSSIBLE
- SEE MODEL FOR DETAIL
- DESK TO BE HINGED TO FLIP UPWARDS
- HEIGHT TO CHANGE ACORDING TO ACTORS REACH

PLEASE NOTE

THIS DRAWING REPRESENTS VISUAL CONCEPTS AND CONSTRUCTION SUGGESTIONS ONLY. THE DRAUGHTSPERSON IS UNQUALIFIED TO DETERMINE STRUCTURAL APPROPRIATENESS OF THIS DESIGN AND WILL NOT BE RESPONSIBLE FOR IMPROPER ENGINEERING, CONSTRUCTION, RIGGING, HANDLING OR USE OF THIS SCENERY. IF PROFESSIONAL ADVICE/ DOCUMENTATION IS RECOMMENDED, IT MUST BE SOUGHT. ALL MATERIALS AND CONSTRUCTION MUST COMPLY WITH LOCAL FIRE AND SAFETY REGULATIONS. IF IN DOUBT... ASK!

ALL DIMENSIONS IN MM UNLESS STATED OTHERWISE.

#DEPT

luned_gwawr@hotmail.com

PROJECT:
#PROJECT CHRISTMAS CAROL

SHEET TITLE:
L DESIGN DRAWINGS.dwg
####

DIRECTOR:
#DIR
DESIGNER:
#DES RACHAEL CANNIN

LIGHTING DESIGNER:
#LX
SOUND DESIGNER:
#SND

PRODUCTION MANAGER:
#PM
3D OFFICE CONTACT:
#3DOFFICE X####

DRAWN BY:
LUNED
APPROVED BY:
NOT CHECKED

VENUE:
#VENUETRAMWAY

DATE:
15/08/18

SCALE:
Custom1.25 @A3L

REF. NUMBER:

/MAS/CAR## /9

WARDROBE

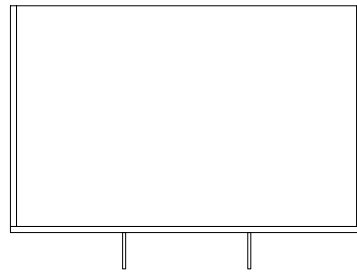

PLAN

NOTES:

- TO BE AS LIGHT AS POSSIBLE TO PUSH WITH PERSON HIDDEN INSIDE
- WHEN DRESSING GOWN IS HUNG ON HOOKS SECRET DOOR TO BE OPENED FROM INSIDE SO IT CAN BE 'UNLOCKED' WITH KEY
- SECRET DOOR SIDE TBC - DEPENDING ON REHERSALS/ACTOR
- ORNATE DECORATIVE HOOK AND DOOR HANDLE PLATES, VICTORIAN STYLE
- *ASK FOR REFERENCE IF NEEDED*
- CASTERS TO BE HIDDEN AND HOUSED BEHIND MOULDING
- CURTAIN IN BACK TO CONCEAL ACTOR FROM VIEW

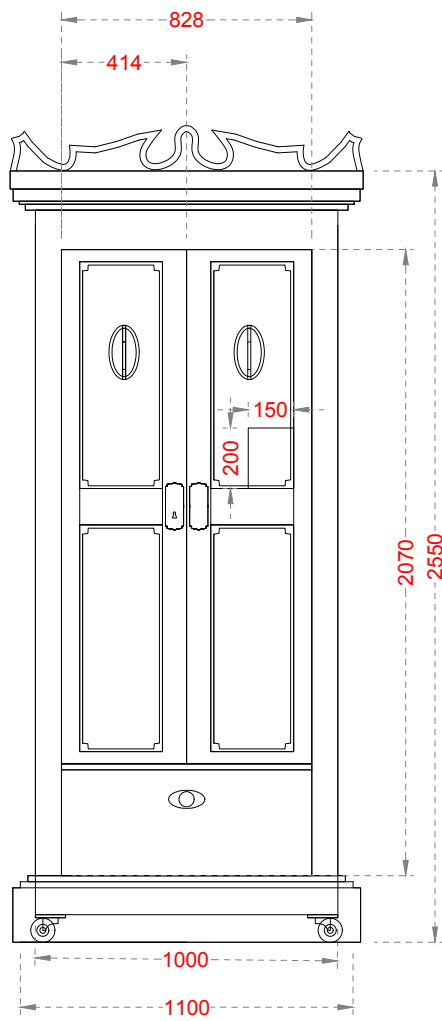

FRONT ELEVATION

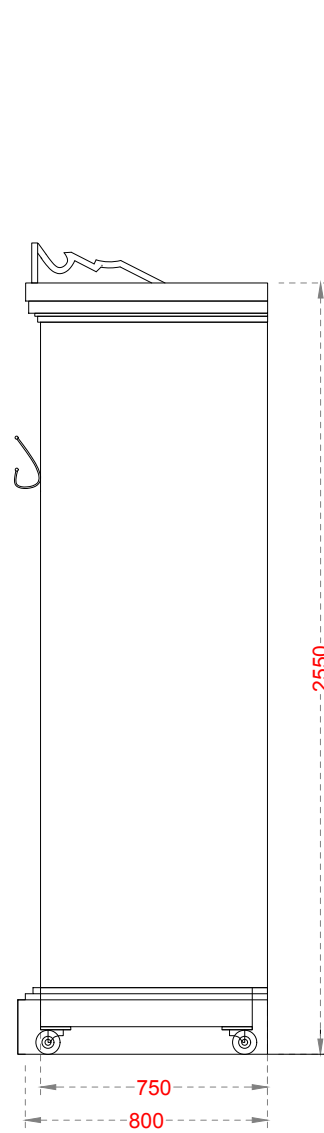

SIDE ELEVATION

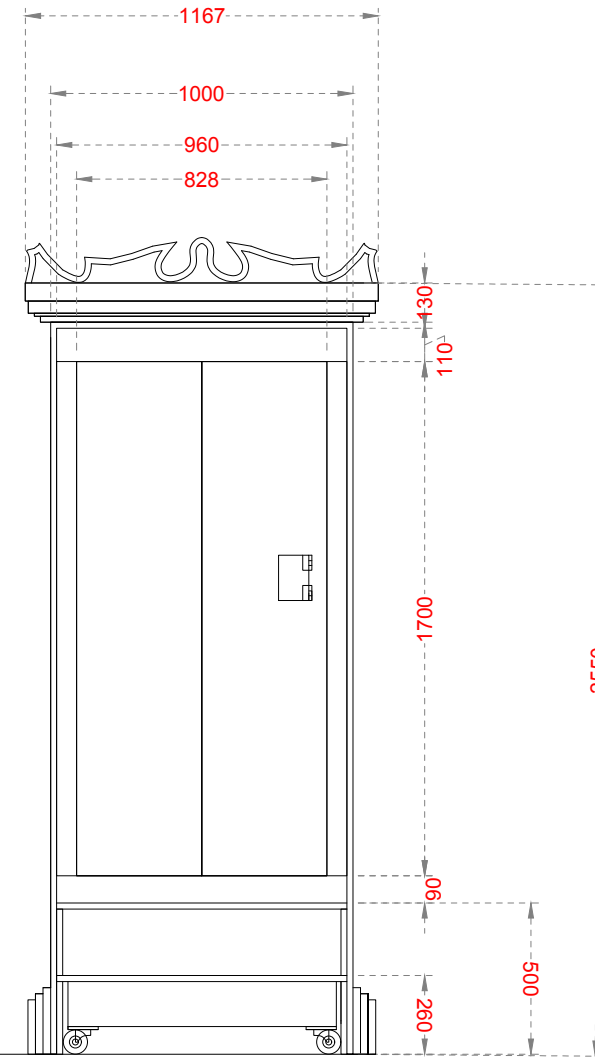

BACK ELEVATION

PLEASE NOTE

THIS DRAWING REPRESENTS VISUAL CONCEPTS AND CONSTRUCTION SUGGESTIONS ONLY. THE DRAUGHTSPERSON IS UNQUALIFIED TO DETERMINE STRUCTURAL APPROPRIATENESS OF THIS DESIGN AND WILL NOT BE RESPONSIBLE FOR IMPROPER ENGINEERING, CONSTRUCTION, RIGGING, HANDLING OR USE OF THIS SCENERY. IF PROFESSIONAL ADVICE/ DOCUMENTATION IS RECOMMENDED, IT MUST BE SOUGHT. ALL MATERIALS AND CONSTRUCTION MUST COMPLY WITH LOCAL FIRE AND SAFETY REGULATIONS. IF IN DOUBT... ASK!

ALL DIMENSIONS IN MM UNLESS STATED OTHERWISE.

#DEPT

PROJECT: #PROJECT CHRISTMAS CAROL

VENUE: #VENUETRAMWAY

SHEET TITLE: L DESIGN DRAWINGS.dwg
####

DATE: 15/08/18 SCALE: Custom1.25 @A3L

DIRECTOR: #DIR	LIGHTING DESIGNER: #LX	PRODUCTION MANAGER: #PM	DRAWN BY: LUNED
DESIGNER: #DES RACHAEL CANNING	SOUND DESIGNER: #SND	3D OFFICE CONTACT: #3DOFFICE X####	APPROVED BY: NOT CHECKED

REF. NUMBER:

/MAS/CAR## /9

luned_gwawr@hotmail.com

NOTES

- TOTAL LENGTH TO BE DISCUSSED IN RELATION TO PIVOT MOTION

PLAN

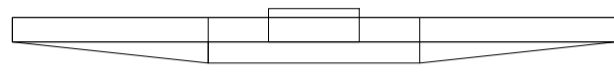

SIDE ELEVATION

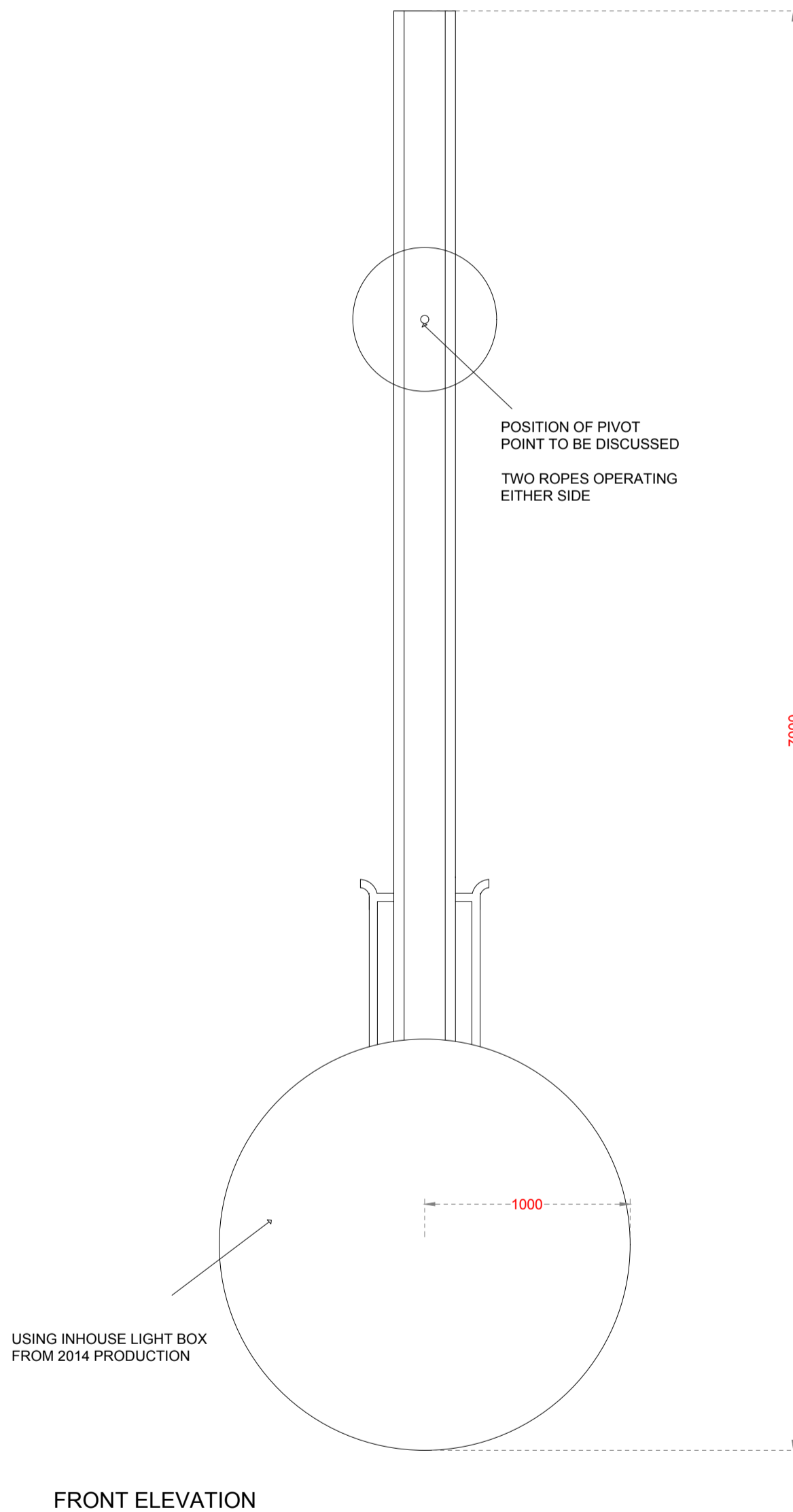
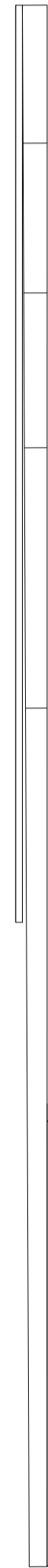

FRONT ELEVATION

PLEASE NOTE

THIS DRAWING REPRESENTS VISUAL CONCEPTS AND CONSTRUCTION SUGGESTIONS ONLY. THE DRAUGHTSPERSON IS UNQUALIFIED TO DETERMINE STRUCTURAL APPROPRIATENESS OF THIS DESIGN AND WILL NOT BE RESPONSIBLE FOR IMPROPER ENGINEERING, CONSTRUCTION, RIGGING, HANDLING OR USE OF THIS SCENERY. IF PROFESSIONAL ADVICE/ DOCUMENTATION IS RECOMMENDED, IT MUST BE SOUGHT.
ALL MATERIALS AND CONSTRUCTION MUST COMPLY WITH LOCAL FIRE AND SAFETY REGULATIONS. IF IN DOUBT... ASK!

ALL DIMENSIONS IN MM UNLESS STATED OTHERWISE.

#DEPT Tel: 020 7452 3333 Fax: 020 7452 3430 luned@nationaltheatre.org.uk	PROJECT: #PROJECT	VENUE: #VENUE	DATE: 15/08/18	SCALE: Custom 1.25
	SHEET TITLE: L DESIGN DRAWINGS.dwg		REF. NUMBER: CHRIS/MAS/CAR# /9	
	DIRECTOR: #DIR	LIGHTING DESIGNER: #LX	PRODUCTION MANAGER: #PM	DRAWN BY: LUNED
	DESIGNER: #DES	SOUND DESIGNER: #SND	3D OFFICE CONTACT: #3DOFFICE X###	APPROVED BY: NOT CHECKED

CLOUDS

NOTES:
 - REFERENCE WILL BE PROVIDED FOR CLOUDS
 - TO BE MADE OF 6MM PLY - DESIGNER TO DISCUSS WITH BUILDERS
 - DISTANCE BETWEEN EACH PIECE 40MM-60MM TO DISCUSS WITH BUILDERS
 - REFER TO MODEL

CLOUD 1

- LAYER 1
- LAYER 2
- LAYER 3
- LAYER 4
- LAYER 5

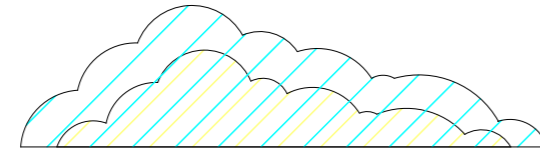

FRONT VIEW

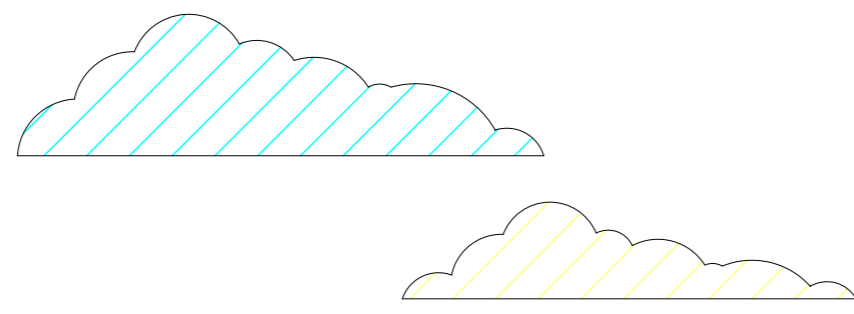

INDIVIDUAL PANELS



PLAN

CLOUD 2

- LAYER 1
- LAYER 2
- LAYER 3
- LAYER 4
- LAYER 5

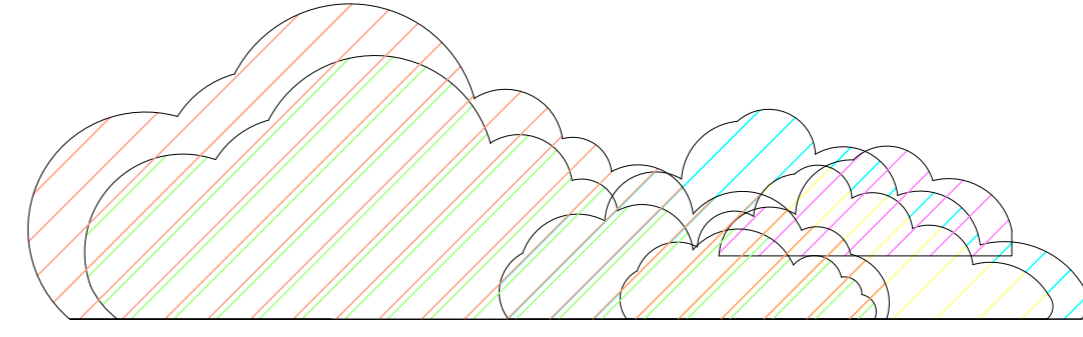

FRONT VIEW

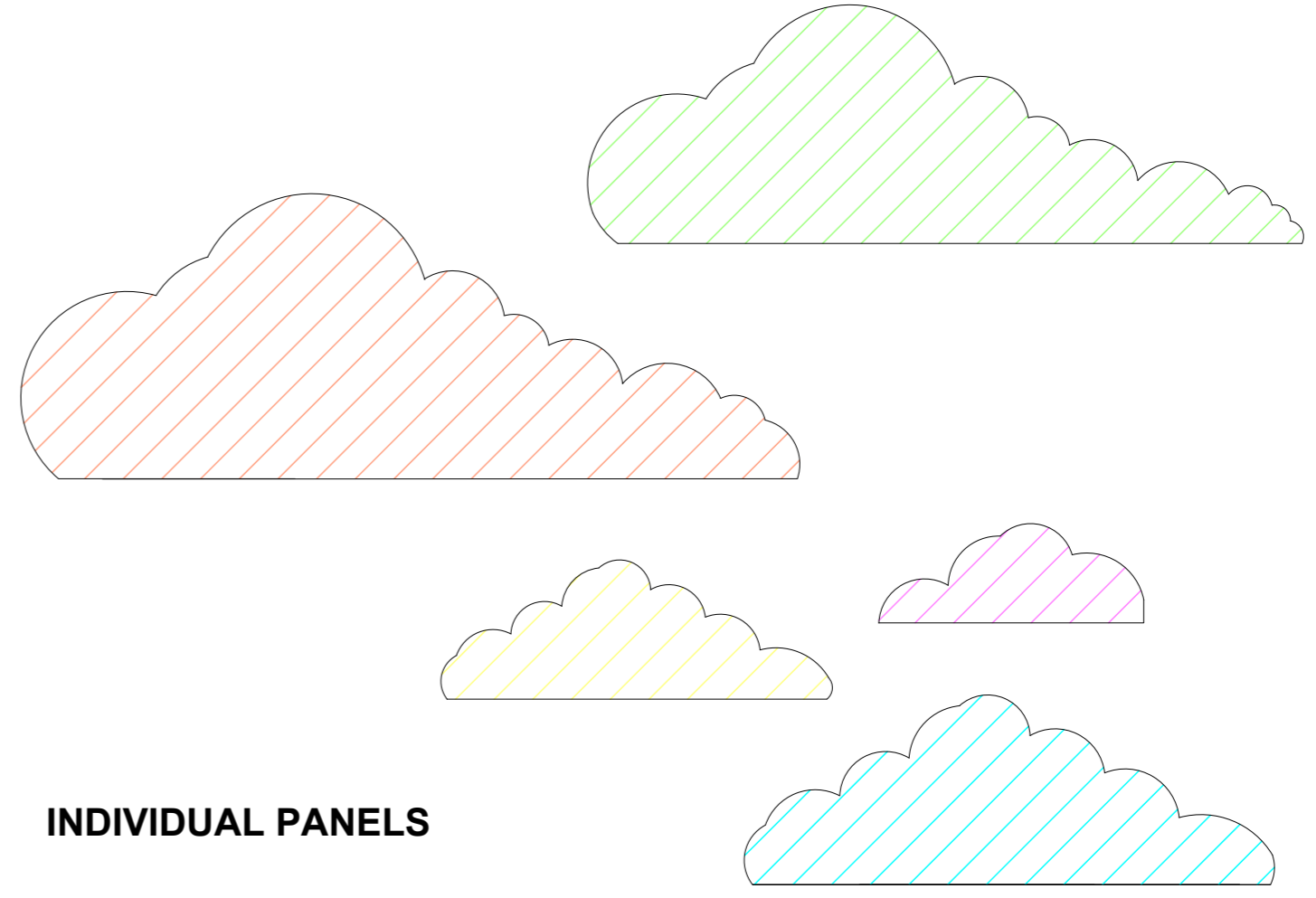

INDIVIDUAL PANELS

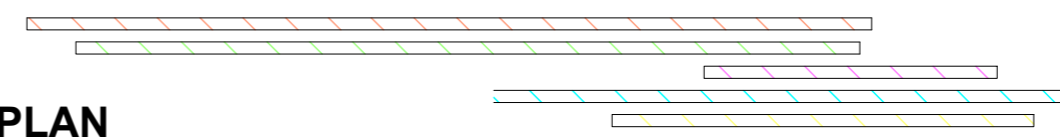

PLAN

CLOUD 3

- LAYER 1
- LAYER 2
- LAYER 3
- LAYER 4
- LAYER 5

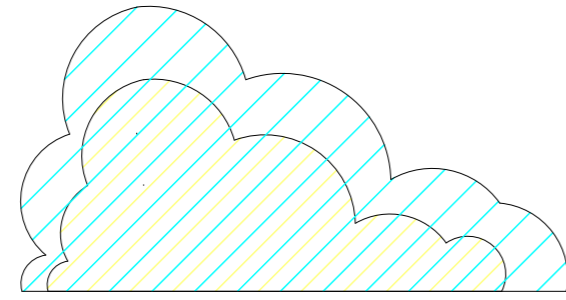

FRONT VIEW

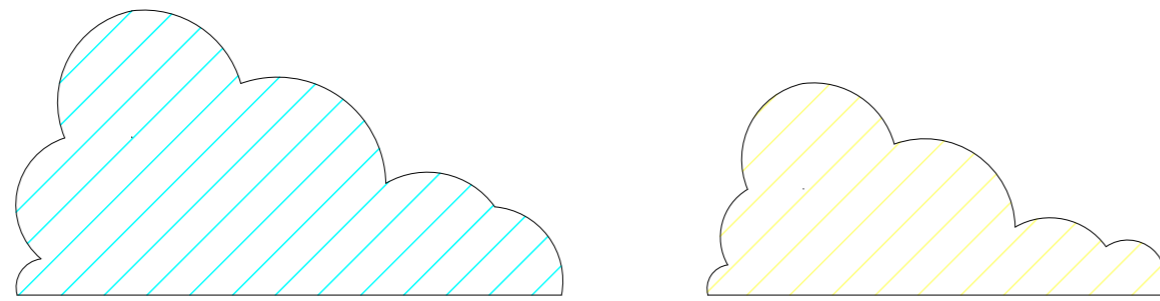

INDIVIDUAL PANELS



PLAN

CLOUD 4

- LAYER 1
- LAYER 2
- LAYER 3
- LAYER 4
- LAYER 5

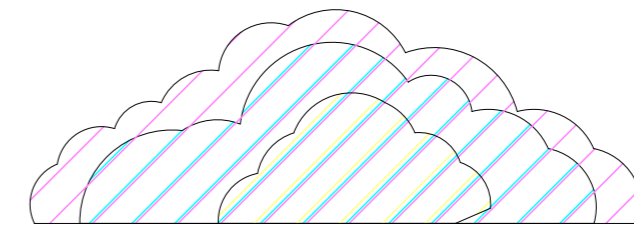

FRONT VIEW



INDIVIDUAL PANELS

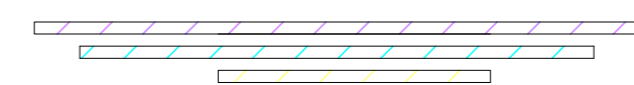

PLAN

PLEASE NOTE
 THIS DRAWING REPRESENTS VISUAL CONCEPTS AND CONSTRUCTION SUGGESTIONS ONLY. THE DRAUGHTSPERSON IS UNQUALIFIED TO DETERMINE STRUCTURAL APPROPRIATENESS OF THIS DESIGN AND WILL NOT BE RESPONSIBLE FOR IMPROPER ENGINEERING, CONSTRUCTION, RIGGING, HANDLING OR USE OF THIS SCENERY. IF PROFESSIONAL ADVICE/ DOCUMENTATION IS RECOMMENDED, IT MUST BE SOUGHT.
 ALL MATERIALS AND CONSTRUCTION MUST COMPLY WITH LOCAL FIRE AND SAFETY REGULATIONS. IF IN DOUBT... ASK!
 ALL DIMENSIONS IN MM UNLESS STATED OTHERWISE.

PROJECT	#PROJECT	VENUE	#VENUE
SHEET TITLE	L DESIGN DRAWINGS.dwg		
DEPT	#DEPT		
DATE	15/08/18	SCALE	Custom1.25 A1P
REF. NUMBER	CHRIS/MAS/CAR# /9		
DRAWN BY	CHKD BY	DATE	NOT CHECKED
DESIGNED BY	REVISIONS	OFFICE	

CLOUD 5

- LAYER 1
- LAYER 2
- LAYER 3
- LAYER 4
- LAYER 5

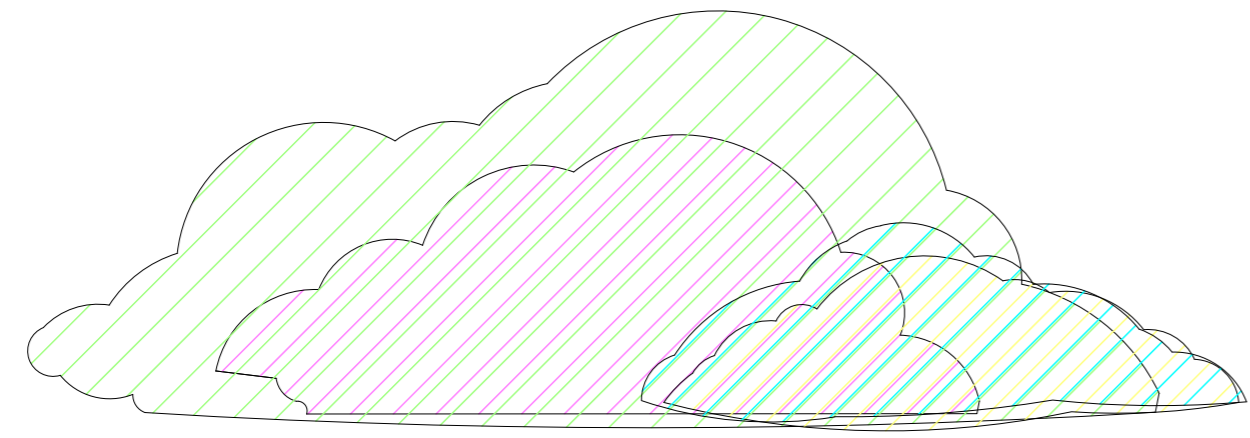

FRONT VIEW

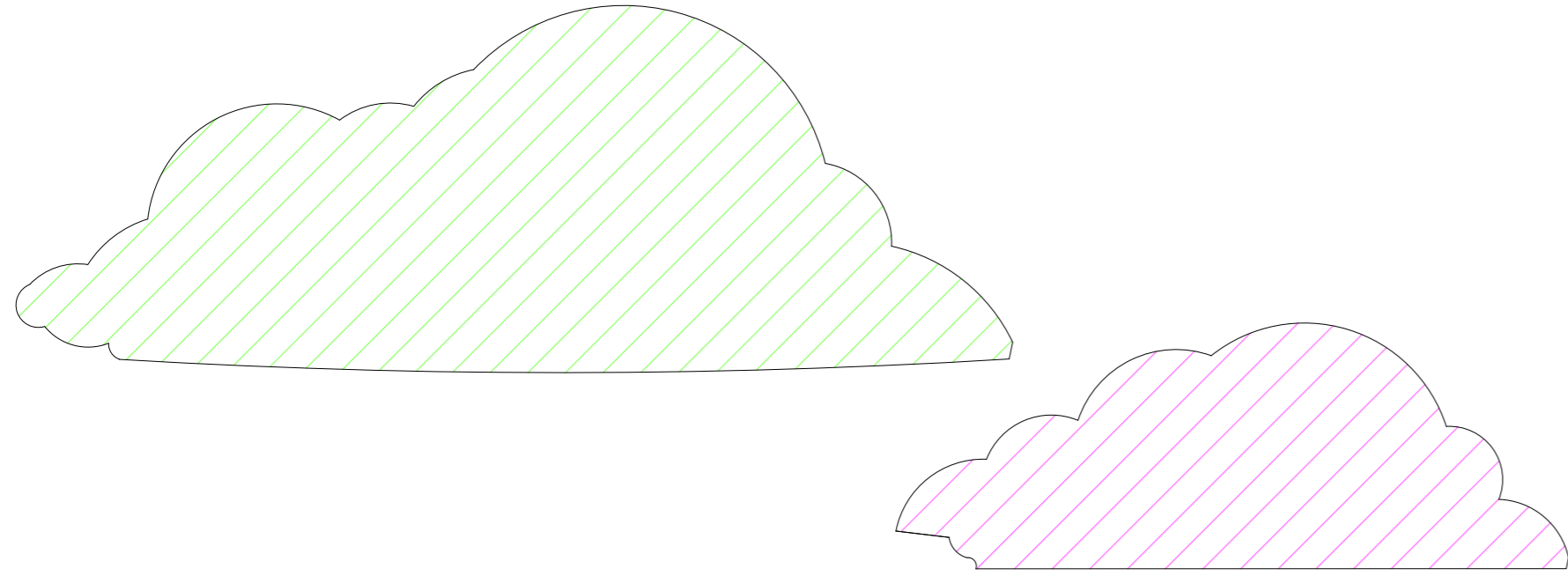

INDIVIDUAL PANELS

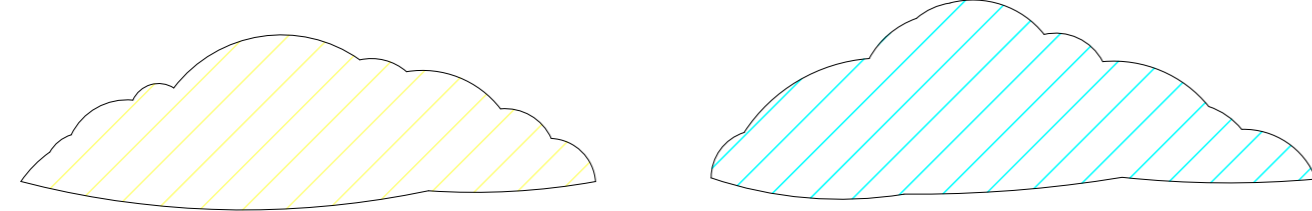

PLAN

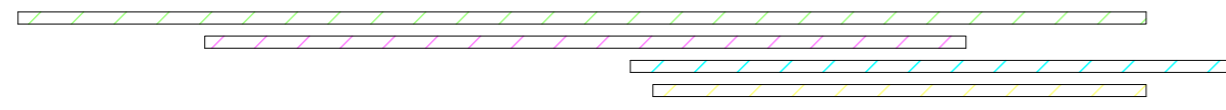

CLOUD 6

- LAYER 1
- LAYER 2
- LAYER 3
- LAYER 4
- LAYER 5
- LAYER 6
- LAYER 7
- LAYER 8
- LAYER 9

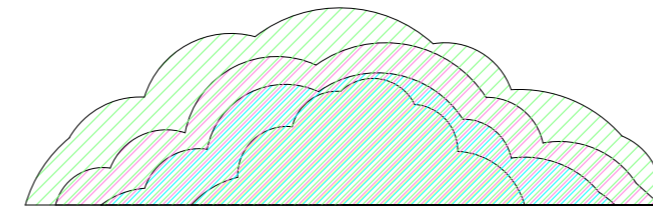

FRONT VIEW

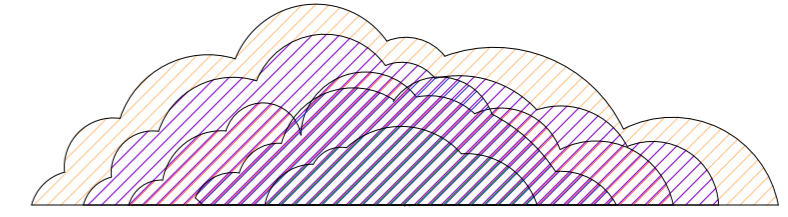

BACK VIEW

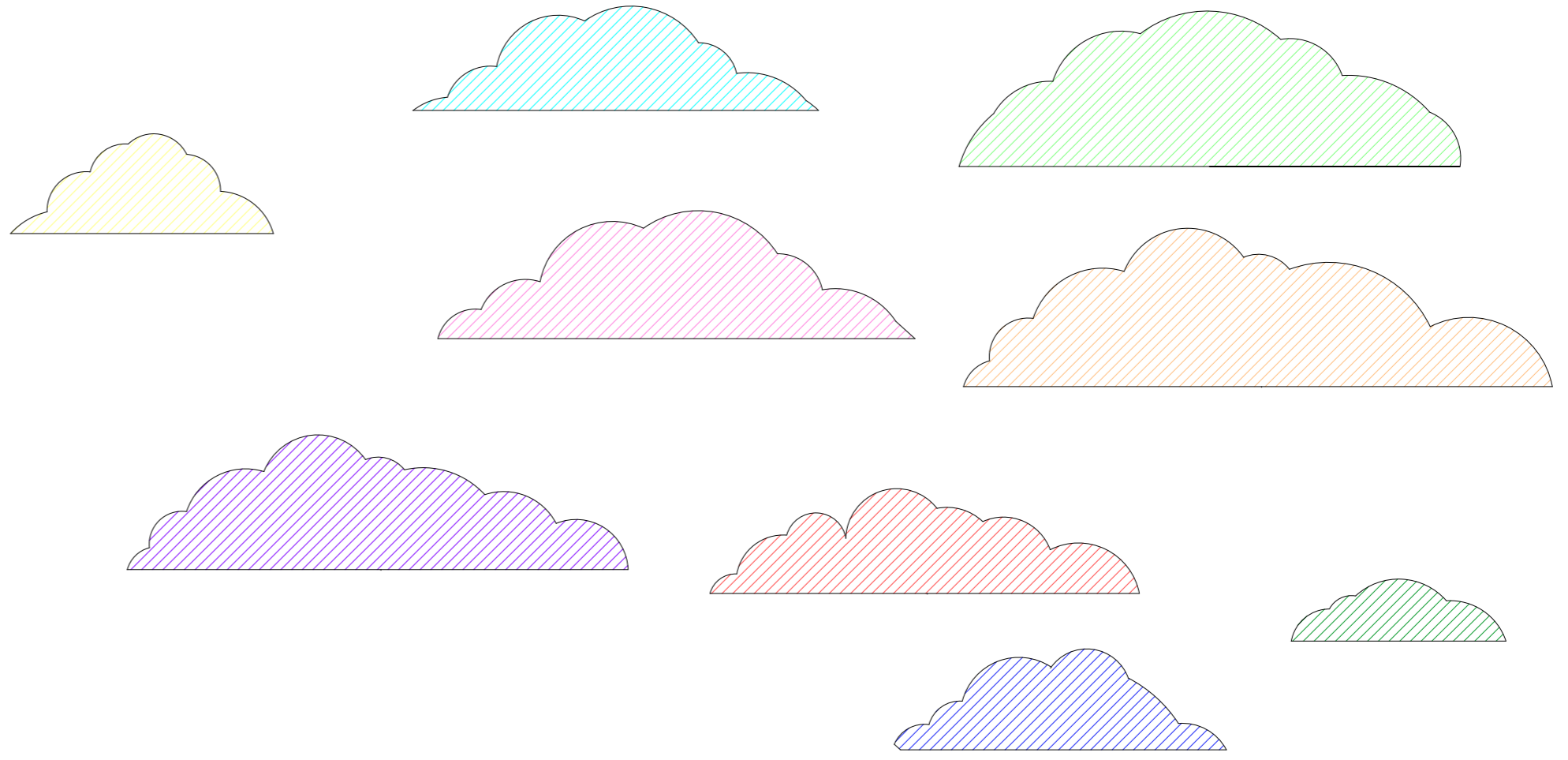

INDIVIDUAL PANELS

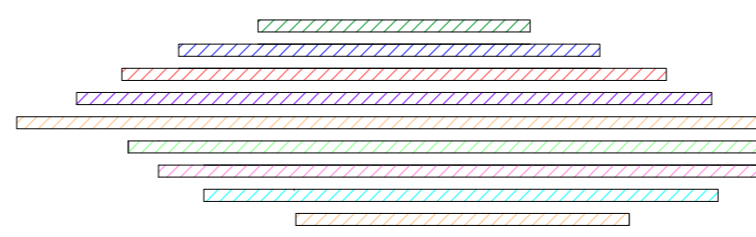

PLAN

CLOUD 7

- LAYER 1
- LAYER 2
- LAYER 3
- LAYER 4
- LAYER 5
- LAYER 6
- LAYER 7
- LAYER 8
- LAYER 9

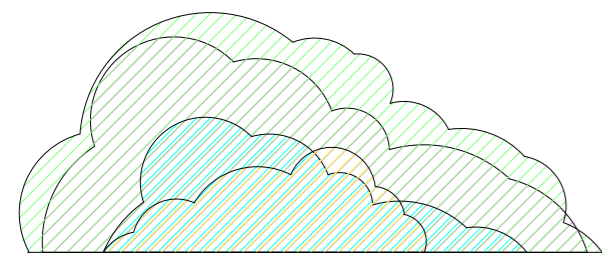

FRONT VIEW

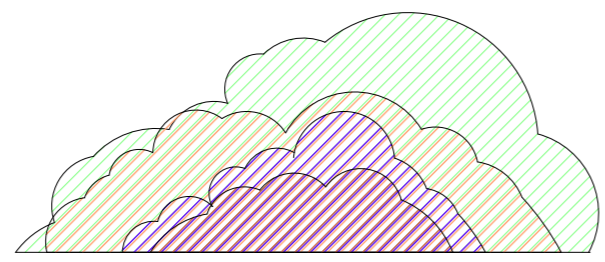

BACK VIEW

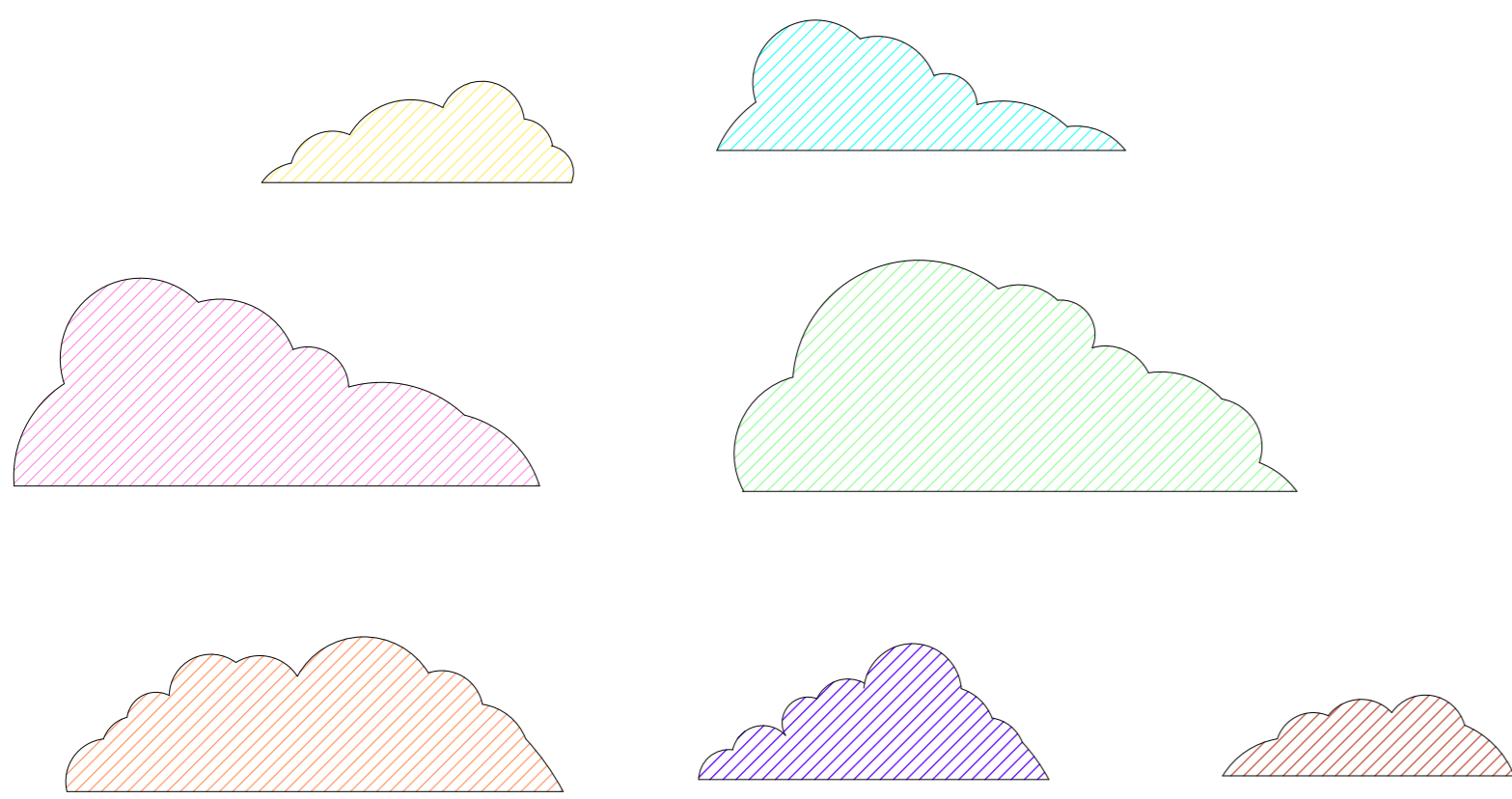

INDIVIDUAL PANELS

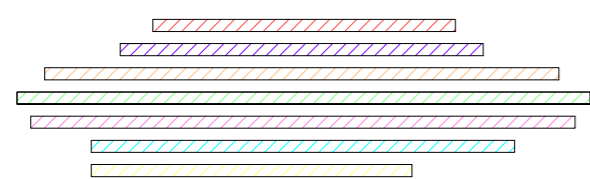

PLAN

CLOUD 8

- LAYER 1
- LAYER 2
- LAYER 3
- LAYER 4
- LAYER 5
- LAYER 6
- LAYER 7
- LAYER 8
- LAYER 9

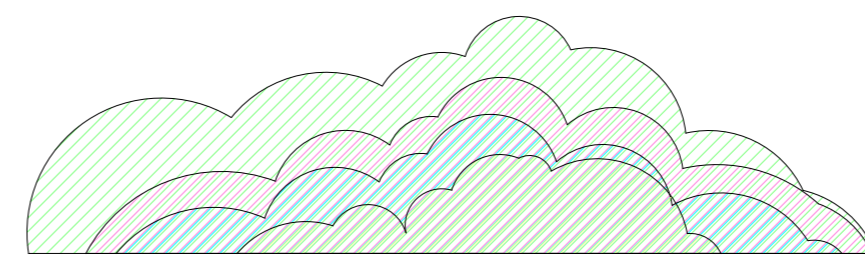

FRONT VIEW

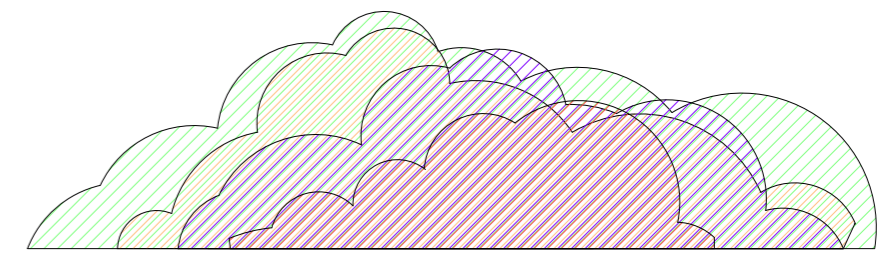

BACK VIEW

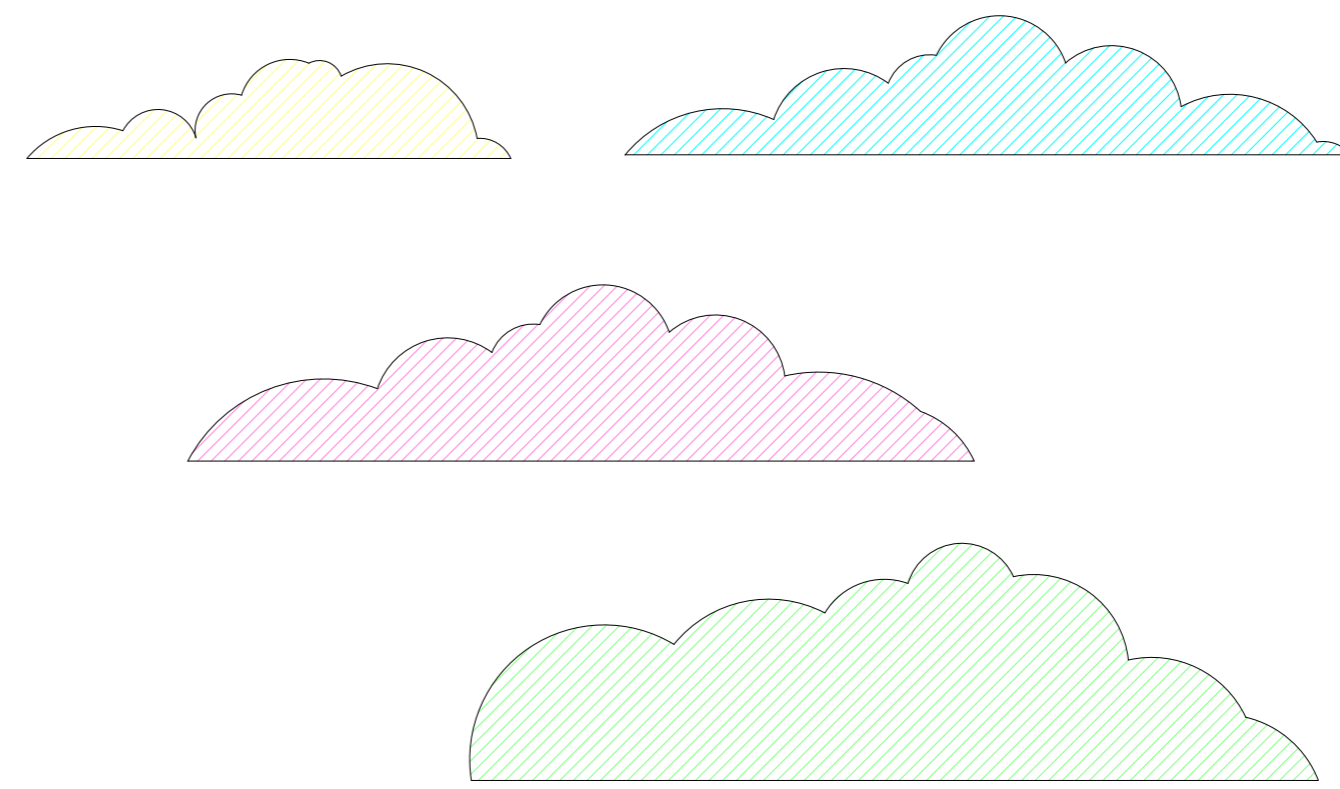

INDIVIDUAL PANELS

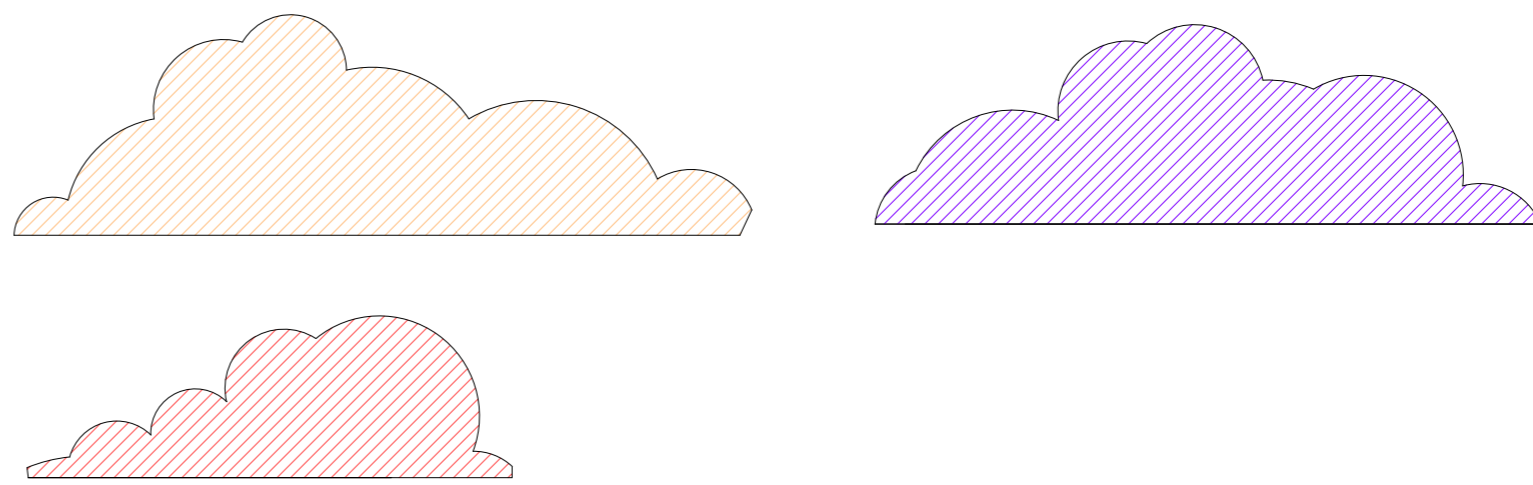

PLAN

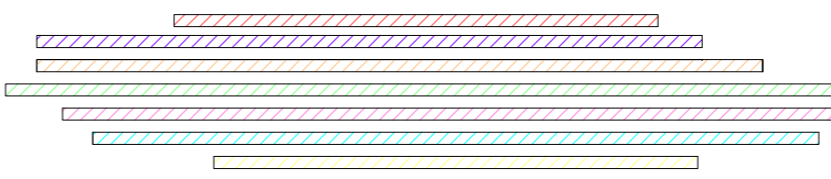

PLEASE NOTE
 THIS DRAWING REPRESENTS VISUAL CONCEPTS AND CONSTRUCTION SUGGESTIONS ONLY. THE DRAUGHTSPERSON IS UNQUALIFIED TO DETERMINE STRUCTURAL APPROPRIATENESS OF THIS DESIGN AND WILL NOT BE RESPONSIBLE FOR IMPROPER ENGINEERING, CONSTRUCTION, RIGGING, HANDLING OR USE OF THIS SCENERY. IF PROFESSIONAL ADVICE/ DOCUMENTATION IS RECOMMENDED, IT MUST BE SOUGHT.
 ALL MATERIALS AND CONSTRUCTION MUST COMPLY WITH LOCAL FIRE AND SAFETY REGULATIONS. IF IN DOUBT... ASK!
 ALL DIMENSIONS IN MM UNLESS STATED OTHERWISE.

PROJECT #PROJECT		VENUE #VENUE	
SHEET TITLE L DESIGN DRAWINGS.dwg			
###			
#DEPT	DATE 15/08/18	SCALE Custom 1.25	REF. NUMBER CHRIS/MAS/CAR# /9
#DR	#PLX	#PM	#LUNED
#BDR	#BKS	#BPC	#BDE
#DES	#RND	#OFFICE X###	NOT CHECKED